



soop mini

loomma



bomma

inspiration



SOAP MINI

The magical quality of iridescence

Varied colors, transparency and continuously changing shapes – the characteristic features of soap bubbles-- inspired this BOMMA collection. The entire collection is produced using the technique of hand-blowing without a form. The Soap Mini collection allows unlimited space for your creativity, with the option to create as large groups of crystal drops as you fancy – from smaller compositions to expansive light constellations.

Design by Ota Svoboda

production





projects



BOMMA catalogue, 2021



BOMMA Atelier, Prague, 2021 - installation of 142 pcs



Installation of 110 pcs of silver and blue soap mini



Canopy of 26 pcs of frosted and clear soap mini

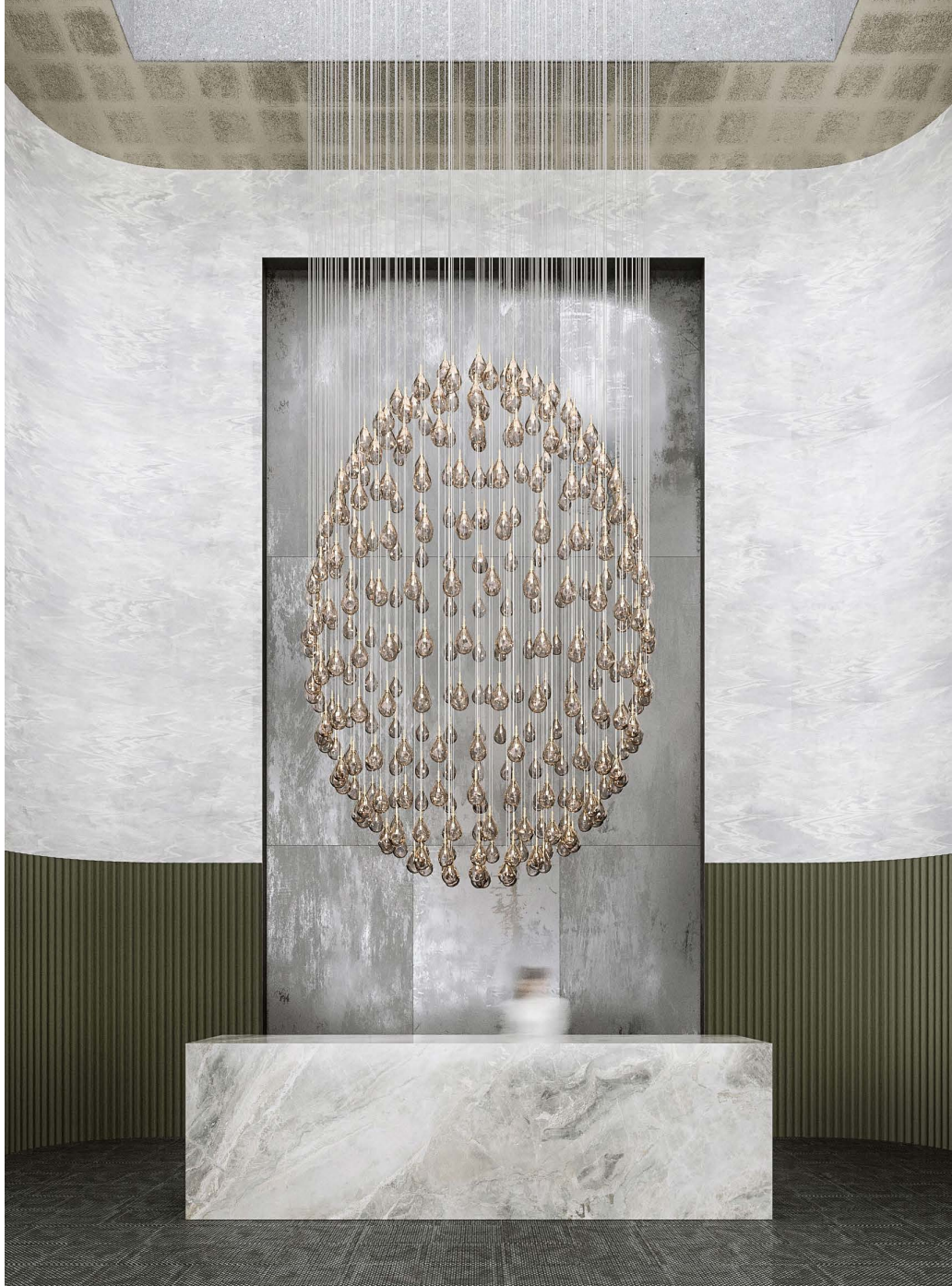

Installation of 330 pcs of gold soap mini

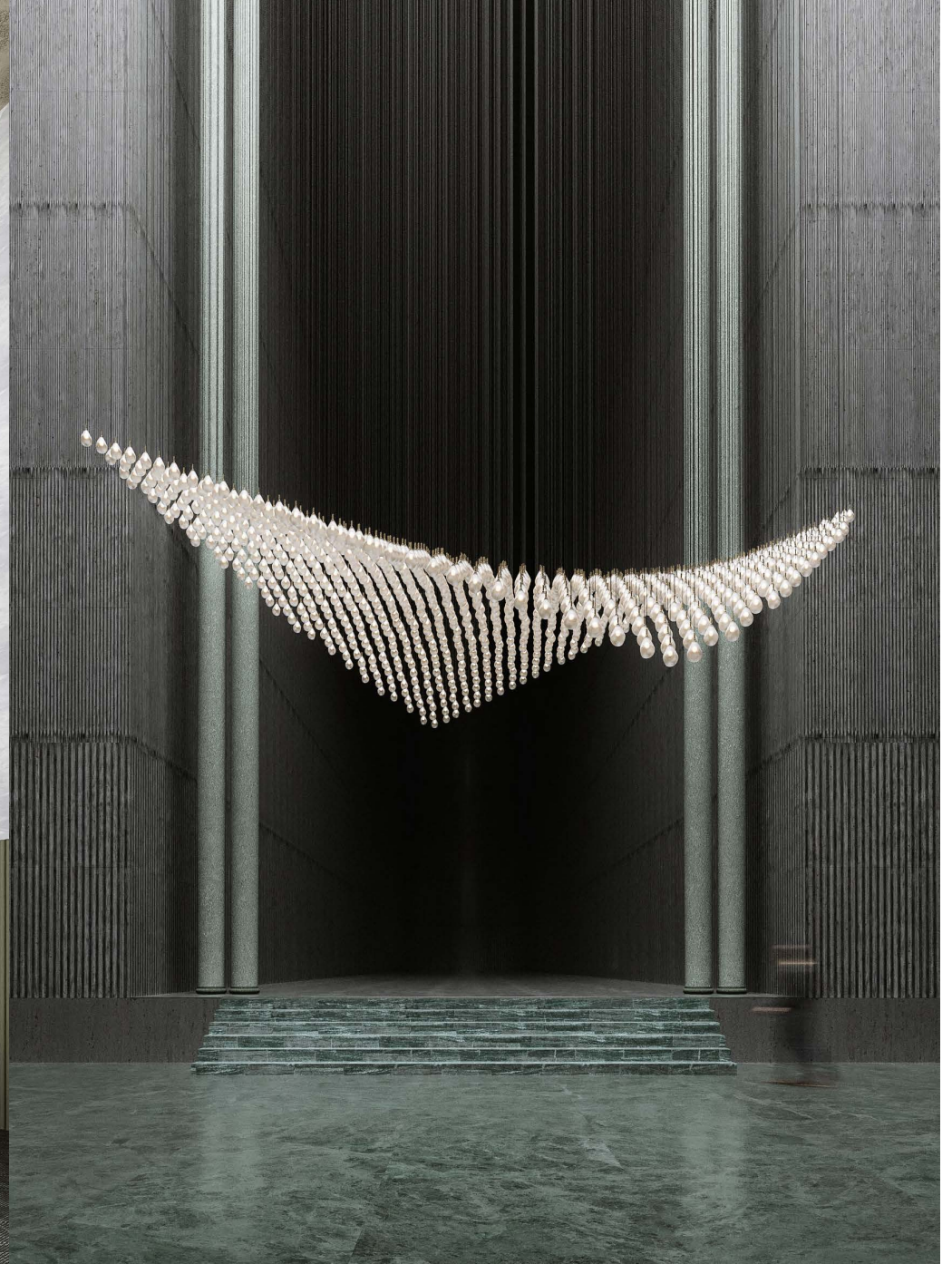

Installation of 1070 pcs of frosted soap mini



Installation of 26 pcs of silver soap mini



Installation of 26 pcs of silver soap mini



Installation of 12 pcs of blue, gold and silver soap mini

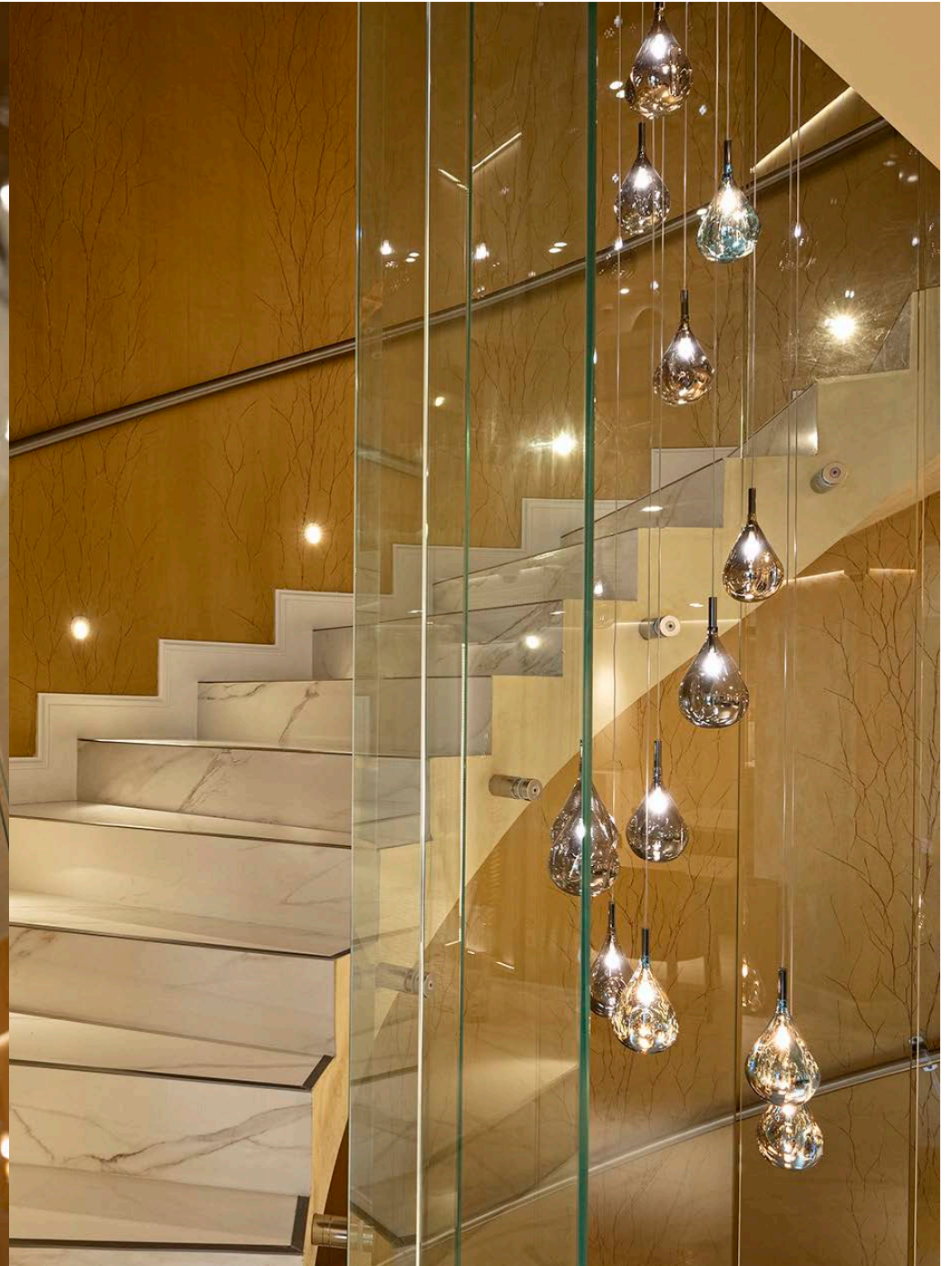

Installation of 12 pcs of blue, gold and silver soap mini

options



blue
anthracite



silver
brushed gold



gold
brushed gold



clear
anthracite



frosted
anthracite

pendant large

Glass options: blue, silver, gold, clear, frosted
Fitting options: anthracite, brushed gold

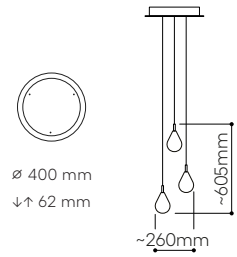

3 pendants

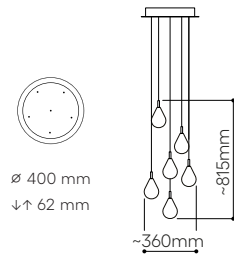

6 pendants

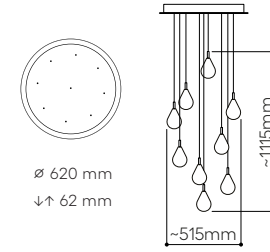

9 pendants

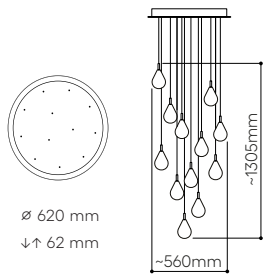

12 pendants

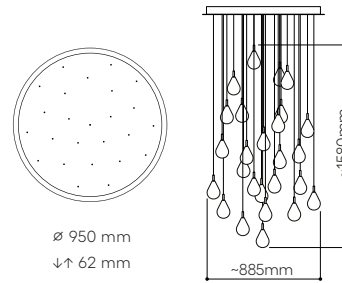

26 pendants

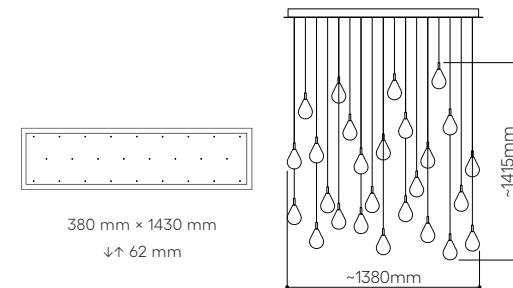

26 pendants
rectangular

chandeliers

technical informations

SOAP MINI pendant

Design by
Ota Svoboda

All Bomma products are hand-made from mouth-blown lead-free crystal. Therefore any small bubbles, non-melts and irregularities in the glass are both proof and a characteristic feature of this traditional craft.

The intensity and color shade of metal-coated glass may vary slightly from product to product. Small dots in the coating, especially visible after the light is on, are not a defect of the product.

When installing and cleaning, touch the coated glass only with the gloves supplied. Failure to do so could cause irreversible damage to the surface. Never use liquid solutions or chemical cleaners to clean the metal-coated glass. Wipe the surface with a soft, dry cloth only.

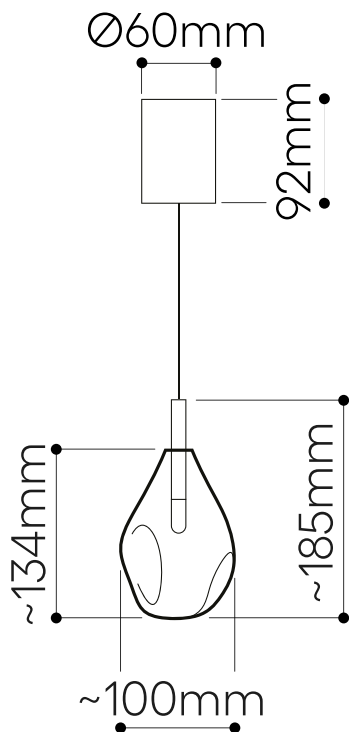

LIGHTING DESCRIPTION

Size	dia. 100 mm, H 185 mm dia. 3,9, inch H 7,3 inch
Cable	transparent 2,5 m / 98,4 inch
Weigh	0,25 kg / 0,48 lb
Material	mouth-blown lead-free crystal in clear, frosted or with metal coating in silver, gold and blue
Mounting Materials	brass and galvanized black nickel / brushed brass
Mounting Colors	anthracit / brushed gold
Protection	IP 20
Nominal voltage	220-230V / A.C. 50 hz (EU) 100-120 V / A.C. 60 Hz (USA)
Class	II. EU / I. USA

LIGHT SOURCE

Type	G4, 1,2W LED, 120 lm
Base	G4 (EU) / G4 (USA)
Voltage	12V, AC
Temperature	2700 K
Color index	RA 90+
Dimming	Dimmable with 0/1-10VDC, on demand dimmable with TRIAC.

TRANSFORMER

Primary	100-240V, 50/60 Hz, 0,04A
Secondary	DC 700mA (0,5V-4V) 1x3W

PACKAGING

Material	Cardboard
Size	195 × 170 × 170 mm 7,6 × 6,6 × 6,6 inch

Origin: traditionally produced in the Czech Republic
Intellectual property license holder: Bomma Czech Republic (EU)
represented by Bohemia Machine s.r.o.

BMRC Group s.r.o.
Hvězdova 1716/2b,
Prague 4, 140 00,
Czech Republic

info@bomma.cz

step beyond